



YANMAR EUROPE BV

Brugplein 11
1332 BS ALMERE
www.yanmar.eu

DEALER:

the latest integrated design for advanced tractor power

TECHNOLOGY YOU DEMAND

YANMAR tractors are well established throughout Europe, designed and built to make light of the heaviest applications across farms or in larger gardens. Not only in Europe, but worldwide, people rely on YANMAR engineered agricultural products.

GK Series tractors are the most compact in the YANMAR range. Smaller in dimensions but with all the tractor technology you demand, the most compact tractors from YANMAR are as powerful and versatile as the biggest models in the line-up.

ENGINEERED STRENGTH

YANMAR's GK Series has all the power to complete a diversity of jobs for you with ease and comfort, yet these tough, durable tractors are extremely compact in design. Their engineered strength will allow you to handle much larger tasks while the compactness enables tighter turns and smoother handling.



The GK Series is a further result of YANMAR's Solutioneering together. With decades of experience in developing and building tractors, YANMAR offers you yet another series of tractors to exceed all expectations. Benefit from the Japanese quality of build and feel the built-in dedication to your needs as you work with this advanced technology.

It is time to start enjoying your work with a new tractor from YANMAR.

THE COMPACT GK 160

For the European market the YANMAR GK 160 is the first to be offered from the new, compact GK Series. With models at 16 HP and 20 HP, available in different combinations, there will be a GK 160 to fit your every requirement.

The tractor is equipped with a three-point linkage and has a lifting capacity of 550 kg. This makes this highly efficient unit a very powerful workhorse. The economical YANMAR diesel engine is strong and runs quietly and smoothly.

Power is transferred to the wheels via an ultra-efficient transmission and gives you that extra traction you may need. Many agricultural and garden implements can be used in combination with the GK 160.

The most compact YANMAR tractor on the market can do big things for you. Harness the power to improve your productivity.

OVERVIEW FROM PLATFORM

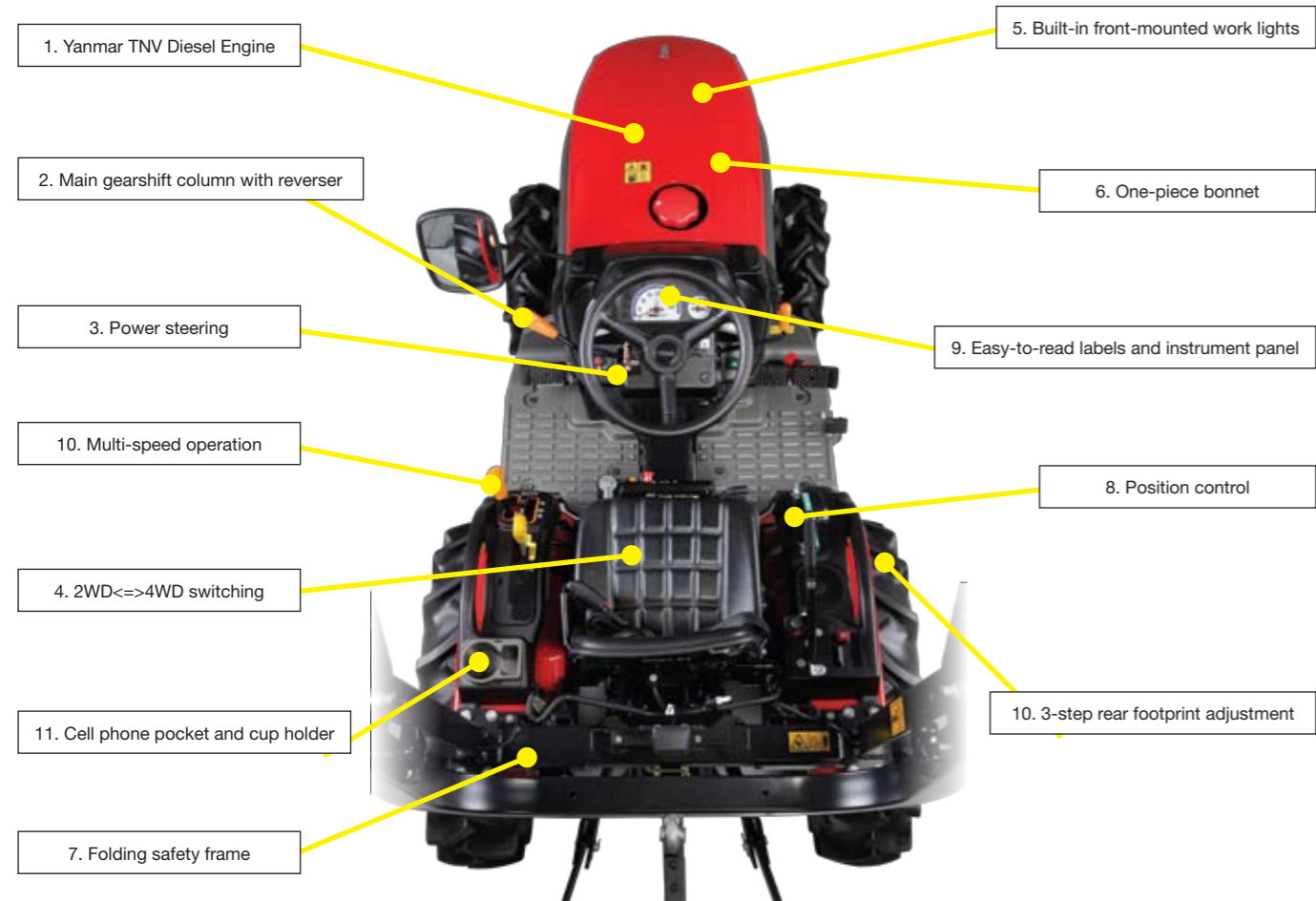

FEATURES FROM GK



YANMAR TNV DIESEL ENGINE
GK Series tractors come with a compact and powerful 3-cylinder liquid-cooled diesel engine developed through Yanmar's original technology. This diesel engine provides tough, indefatigable work capacity, offers better mileage than petrol engines, and also excels in durability.



MAIN GEARSHIFT COLUMN WITH REVERSER
A single lever handles both standard gearshift operation and switching to forward/reverse. Situated to the left of the steering wheel, this lever was designed for operator-friendly operation.



BUILT-IN FRONT-MOUNTED WORK LIGHTS
Work lights, located in front on both the right and left sides, brightly and safely illuminate the terrain ahead of the tractor.



2WD<=>4WD SWITCHING
4-wheel drive offers better traction on soft ground, and delivers greater power during work as well. Simple switching to 2-wheel drive prevents damage to turf and other delicate ground during turns.



POWER STEERING – STANDARD EQUIPMENT
Fully hydrostatic power steering is standard function in the GK tractor same as a large-scale tractor. It enables you to make turn the wheel with a minimum effort. It makes overall handling easier and lessens driving fatigue even over long hours or during work that requires turning frequently.

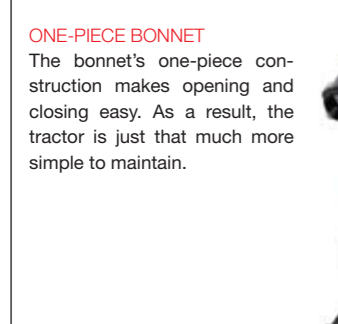

ONE-PIECE BONNET
The bonnet's one-piece construction makes opening and closing easy. As a result, the tractor is just that much more simple to maintain.



DIMENSIONS AND WEIGHTS

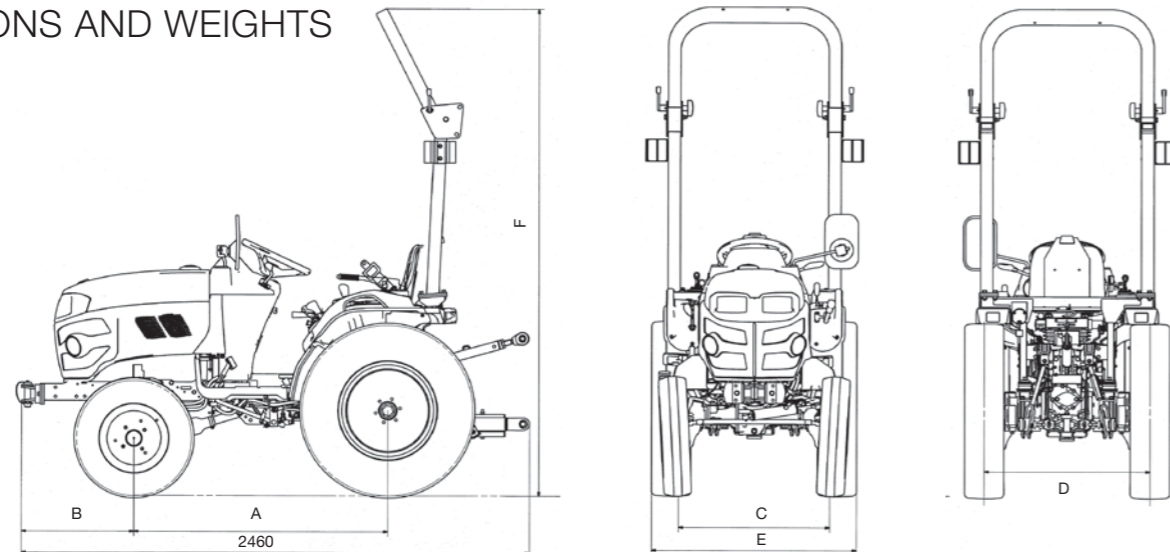

KEY	Tire combination	FRONT		4.5-10	5-12	5.00-12	20x8.00-10
		REAR		7-16	8-16	8-18	212/80-15
A	Overall length including lower link		(mm)	2460			
B	Maximum overall width		(mm)	1049	1049	1090	1065
C	Overall height including ROPS		(mm)	2316	2340	2361	2306
D	Wheelbase	GK160	(mm)	1227			
		GK200	(mm)	1227			
E	Minimum ground clearance		(mm)	217	241	262	207
	Tractor weight	GK160	(kg)	590	600	615	600
		GK200	(kg)	595	605	620	605

Model		GK160	GK200	
Engine	Type	Water-cooled, 4 cycle diesel		
	Injection system	In-direct injection		
	Model	3TNV70	3TNV76	
	Displacement	(cc)	853	1115
	Rated output	ECE-R24	11.1 kW / 2400 rpm	14.2 kW / 2400 rpm
(15.1 PS / 2400 rpm)			(19.3 PS / 2400 rpm)	
Gross horsepower		15.6 PS / 2400 rpm	20.5 PS / 2400 rpm	
Steering		Hydraulic full power steering, standard		
Brake		Mechanical, wet multiple disc		
Transmission	Range	8 forward / 4 reverse		
	Main shift	2 forward, 1 reverse, mechanical		
	Range shift	4 speed, mechanical		
	Differential lock	Mechanical, standard		
Traveling speed at rated engine speed	Forward	km/h	0.50-12.14	
	Reverse	km/h	0.40-6.31	
Rear PTO	Type	Mechanical		
	Shaft	Type 1, 35mm, 6 spline		
	Speed	rpm	540 at 2339 rpm engine speed 579 at 2400 rpm engine rated speed	
Electrical	Battery	12V-36AH		
	Alternator	12V-40AH		
Three point rear linkage	Type	Category 1N		
	Control	Position control		
	Maximum lifting capacity	550 kg at lower link end		
Trailer coupling	Type	Drawbar, standard		
	ROPS	Standard		
Safety	ROPS	Standard		
	Seatbelt	Standard		

SPECIFICATIONS

OPTIONAL EQUIPMENTS



RH SIDE REAR VIEW MIRROR

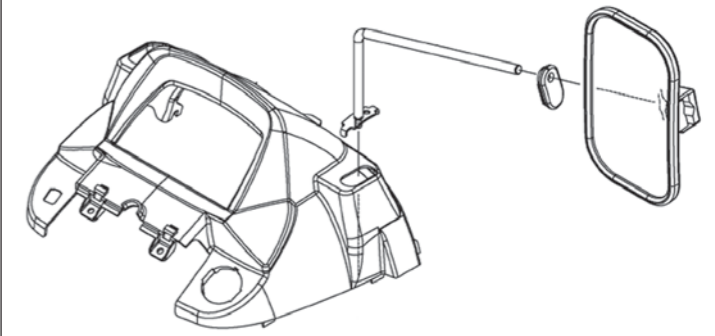

FRONT WEIGHT 20KG

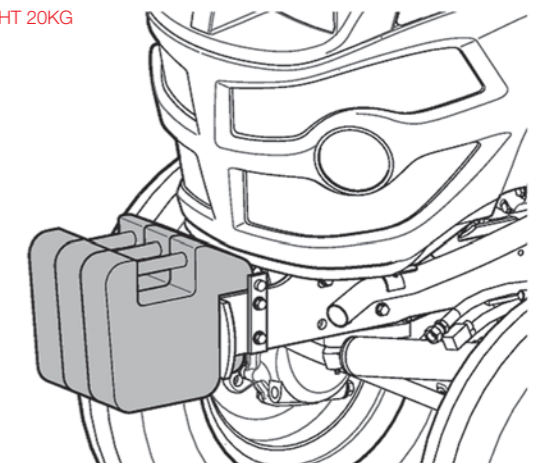

PARTS AND SERVICE



SPARE PARTS

In order to maintain the performance and durability of Yanmar tractors, using genuine parts is a must. The same can be said for repairing and servicing of the Yanmar tractors. You are always close to use. From our factories to Kobe (Japan) distribution centre genuine parts are forwarded to our large logistic hub near Amsterdam. From there we serve Europe.



SERVICE & WARRANTY

Service partners all around Europe are dedicated to offer you service wherever you like. Service engineers are trained by Yanmar to guarantee the quality of the work. Yanmar offers a limited warranty of 2 years on all tractors. In this case you can work with your tractor with out any worries.