



LIGHT BOY

LIGHT BOY series

ELB43SD

**400W Metal Halide Lamp x 4
Cart type / Spotlight**



Compact & Supersilent

- Powerful output of 4 metal halide lamps
- Compact body allows multiple unit transportation
- Unique and reliable safety devices
- Ensure a stable brightness supply by E-ballast.
- Steerable cart design for easy transportation.

Give the Best Performance

- QUICK RESTRIKE TIME**
- YDG300NS** Diesel Gen-set
- E-BALLAST** Electronic ballast

ELB43SD

400W Metal Halide Lamp x 4

LIGHT BOY
SERIES

LONG-LIVED & HIGH EFFICIENCY LAMP

METAL HALIDE LAMP being used for LIGHT BOY is high efficiency, longer life and stronger to vibration compared with HALOGEN LAMP.

Metal Halide (400W)

34,000 lumen

10,000 hours

3.3 A

BRIGHTNESS

LIFE HOURS

REQUIRED AMPERAGE

Halogen (500W)

9,500 lumen

2,000 hours

14.5 A

HIGH EFFICIENCY E-BALLAST

From the wavy line of digital type of electric ballast, even the wavy line get down, the dark area is a quick moment.

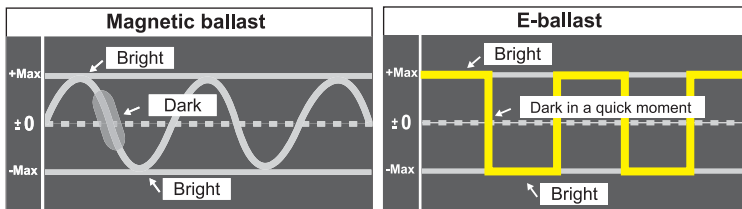

DUSK-DAWN OPERATION WITHOUT FILL-UP

A single tankful of diesel will keep these air-cooled gensets on the go for 21 hours. The secret to such long operation is their low fuel consumption from features like direct injection - a major feat for this type of compact engine. These gensets give savings with every tankful of diesel. And they have a utility-size fuel tank, so you can leave them running all night.



YDG300NS

MULTIPLE UNITS TRANSPORTABLE

As LIGHT BOY is designed very compactly, several units can be transported by one vehicle, or you can utilize an empty space when transporting construction machines.



6 units can be loaded on a 2t truck

EASY TO CHANGE



open-close without a tool. If glass had broken, replace the glass only.

LIGHTING UNIT



can be set to any angle and direction.

ILLUMINATION RANG

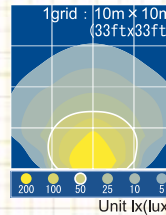

3 STAGE MAST

extends up to 4.1m.

SAFETY LOCK

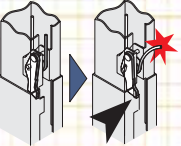

catches the mast in the event of the lifting wire breaking.

SAFETY WINCH



Prevents sudden fall of the mast.

STEERING HANDLE



for easy maneuverability

LIFTING HOOK

for easy transport

OUTRIGGER



Secures the stability of the unit.

BRAKE



Jam on the brakes.

CART

Possible to lift with forklift on the underbody.

SPECIFICATIONS & DIMENSIONS

Lighting Tower	Model		ELB43SD	
	Voltage	V	AC230	
	Current	A	7.8 (1.95x 4 lamps)	
	Lamp	Type		Metal Halide
		Wattage x No. of lamp	W	400 x 4
		Total Luminous Flux	lm	136,000
		Outside temperature	F	23 to 104
	Dimension (LxWxH)	Working	ft.in. (mm)	5'3"x 5'1" x 6'6" to 13'7" 1600 x 1550 x 2060 to 4160
		Storage	ft.in. (mm)	3'4" x 3'3" x 5'6" 1040 x 1030 x 1700
	Mast	Number of Stage		3
Type			Telescopic Manual	
	Weight	kg	115.5	
Generator	Model		YDG300NS	
	Output	Kw	3.0	
	Starting System		Electric	
	Fuel Oil / Tank capacity	L	Diesel Fuel / 14.5	
	Dry Weight	kg	152	
	Total Weight	kg	267.5	

YANMAR CONSTRUCTION EQUIPMENT EUROPE S.A.S.

25, RUE DE LA TAMBOURINE
F-52115 SAINT-DIZIER CEDEX, FRANCE
TEL:+33 3 25 56 39 75 FAX:+33 3 25 56 94 69
<http://www.yanmar.fr>
E-mail: contact@yanmar.fr